

**ArtificialIris**

**Dr. Schmidt<sup>®</sup>**  
Intraocularlinsen



**Foldable iris prosthesis  
custom-made  
for each patient**

## The customized solution

+ for acquired iris defects and traumatic aniridia

+ for congenital aniridia

+ for traumatic mydriasis

Available in two  
versions

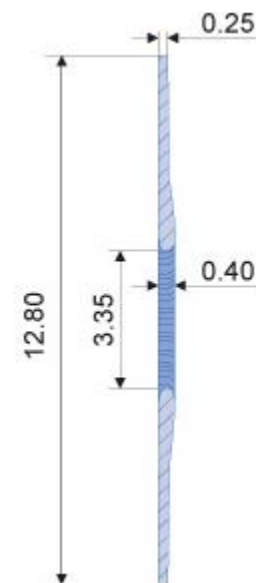

Artificial Iris



Artificial Iris - Fibre Free

## Application – sizing (always)

Custom fit -  
reducing overall  
diameter by cutting  
(trimming) with  
trephine or scissors



## Application – sizing (always)

max. white-to-white + 0.5mm

- ➔ To evaluate size measure horizontal and vertical WTW axis
- ➔ Add a value of 0.5 mm to the longer of both
- ➔ Use this end value to select trephine size

End value	Size of trephine
11.7	➔ Trephine: Ø12.0mm
11.8	
11.9	
12.0	
12.1	
12.2	➔ Trephine: Ø12.5mm
12.3	
12.4	
12.5	
12.6	
≥ 12.7	No trim needed

## Application – full implant – Fiber Free

**ArtificialIris**

– Fibre Free



- After trimming ALWAYS make at least a good size peripheral triangular sector IRIDECTOMY
- Implantation into the ciliary sulcus

## Application – Fiber Free - iridectomy

### ArtificialIris

- Fibre Free



depth of  
iridectomy  
approx. 30-40%  
in relation to  
pupillary rim

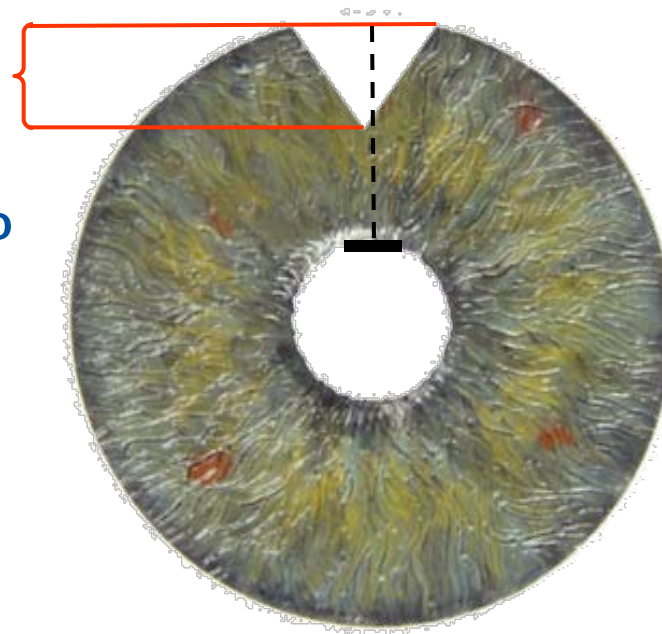

## Rolling the Fibre Free implant with iridectomy



## The ArtificialIris –

➤ **unique solution**

for aniridia  
and iris defects



## Thank you for your attention!



**Dr. Schmidt Intraocularlinsen GmbH**

**Westerwaldstraße 11-13  
53757 Sankt Augustin / Germany**

**[www.artificial-iris.com](http://www.artificial-iris.com)**

**[iris@humanoptics.com](mailto:iris@humanoptics.com)**

